

Euromas Polyester



Detailed product information can be found on www.bopla.de



- 27 sizes
- Listing under UL file no. E 196 706
- Lid screws made of V2A
- Optional silicone lid seal with increased temperature resistance (approx. 130°C)
- Terminals and mounting on request

Colour:

Grey, similar to RAL 7000; special colours on request

Protection class:

IP 66/DIN EN 60529, higher level of protection on request

Enclosure material:

UP-GF 25-30%, PU foamed seal; for details see Technical Information

These polyester enclosures are ideal for use in rough environments



The polyester enclosure is resistant to a large number of chemicals.



Polyester has a higher level of mechanical stability than ABS or PC, but it is lighter than aluminium.



Alternative to the foamed seal: Version with silicone seal for higher temperature resistance available on request.



A hinge can be fitted to the enclosure for easy opening.



Wall brackets can be used to fit the enclosure to the wall – quickly and securely.

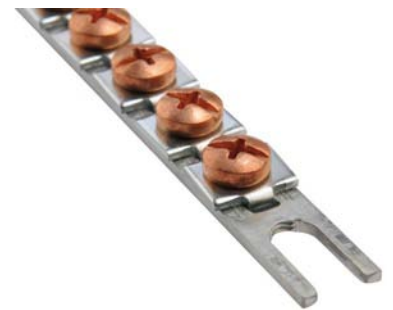

Earthing bars with fitted terminal clamps can be supplied on request.

Euromas Polyester | Enclosures



Enclosure, polyester

Model	Order no.	A	B	C	a1	a2	b1	b2	b3	c1	c2
P 303	04303000	55	55	37,5	45,5	33,5	45,5	33,5		8	26
P 305	04305000	80	75	56,5	70	49	65	32		15	46
P 311	04311000	110	75	56,5	100	79	65	32		15	46
P 316	04316000	160	75	56,5	150	129	65	32		15	46
P 319	04319000	190	75	56,5	180	159	65	32		15	46
P 322	04322000	230	75	56,5	220	199	65	32	50,6	15	46
P 323	04323000	55	55	59	44,5	33,5	44,5	32,5		8	48
P 324	04324000	110	75	75,5	100	79	65	32		15	65
P 325	04325000	160	75	75,5	150	129	65	32		15	65
P 326	04326000	80	75	75,5	70	49	65	32		15	65
P 327	04327000	230	75	75,5	220	199	65	32	50,6	15	65
P 329	04329000	190	75	75,5	180	159	65	32		15	65
P 330	04330000	160	160	91	147	119	147	89		20	79
P 331	04331000	220	120	91	210	179	110	65		25	80
P 332	04332000	122	120	91	112	81	110	65		25	80
P 333	04333000	260	160	91	247	219	147	89		20	79
P 334	04334000	360	160	91	347	319	147	89		20	79
P 336	04336000	320	100	81	309	286	88	44		20	70
P 337	04337000	255	250	121	242	214	237	179		25	109
P 338	04338000	255	250	161	242	214	237	179		65	149
P 339	04339000	360	360	90,8	347	319	347	289		20	79
P 340	04340000	400	250	161	386	358	236	178		65	149
P 341	04341000	400	405	121	386	358	391	333		25	109
P 3412	04341200	400	405	201	384	356	389	331		25	189
P 342	04342000	600	250	121	586	558	236	178	208	25	109
P 345	04345000	560	160	91	547	519	147	89	119	20	79
P 355	04355000	400	250	121	386	358	236	178		25	109

Scope of delivery: Lid and base, lid screws made of V2A, earthing screw

Euromas Polyester | Enclosures

Enclosure, polyester, with silicone lid seal



Model	Order no.	A	B	C	a1	a2	b1	b2	b3	c1	c2
P 305 SIL	04305100	80	75	56,5	70	49	65	32		15	46
P 311 SIL	04311100	110	75	56,5	100	79	65	32		15	46
P 316 SIL	04316100	160	75	56,5	150	129	65	32		15	46
P 319 SIL	04319100	190	75	56,5	180	159	65	32		15	46
P 322 SIL	04322100	230	75	56,5	220	199	65	32	50,6	15	46
P 324 SIL	04324100	110	75	75,5	100	79	65	32		15	65
P 325 SIL	04325100	160	75	75,5	150	129	65	32		15	65
P 326 SIL	04326100	80	75	75,5	70	49	65	32		15	65
P 327 SIL	04327100	230	75	75,5	220	199	65	32	50,6	15	65
P 329 SIL	04329100	190	75	75,5	180	159	65	32		15	65
P 330 SIL	04330100	160	160	91	147	119	147	89		20	79
P 331 SIL	04331100	220	120	91	210	179	110	65		25	80
P 332 SIL	04332100	122	120	91	112	81	110	65		25	80
P 333 SIL	04333100	260	160	91	247	219	147	89		20	79
P 334 SIL	04334100	360	160	91	347	319	147	89		20	79
P 336 SIL	04336100	320	100	81	309	286	88	44		20	70
P 337 SIL	04337100	255	250	121	242	214	237	179		25	109
P 338 SIL	04338100	255	250	161	242	214	237	179		65	149
P 339 SIL	04339100	360	360	90,8	347	319	347	289		20	79
P 340 SIL	04340100	400	250	161	386	358	236	178		65	149
P 341 SIL	04341100	400	405	121	386	358	391	333		25	109
P 3412 SIL	04341300	400	405	201	384	356	389	331		25	189
P 342 SIL	04342100	600	250	121	586	558	236	178	208	25	109
P 345 SIL	04345100	560	160	91	547	519	147	89	119	20	79
P 355 SIL	04355100	400	250	121	386	358	236	178		25	109

Scope of delivery: Lid and base, lid screws made of V2A, earthing screw

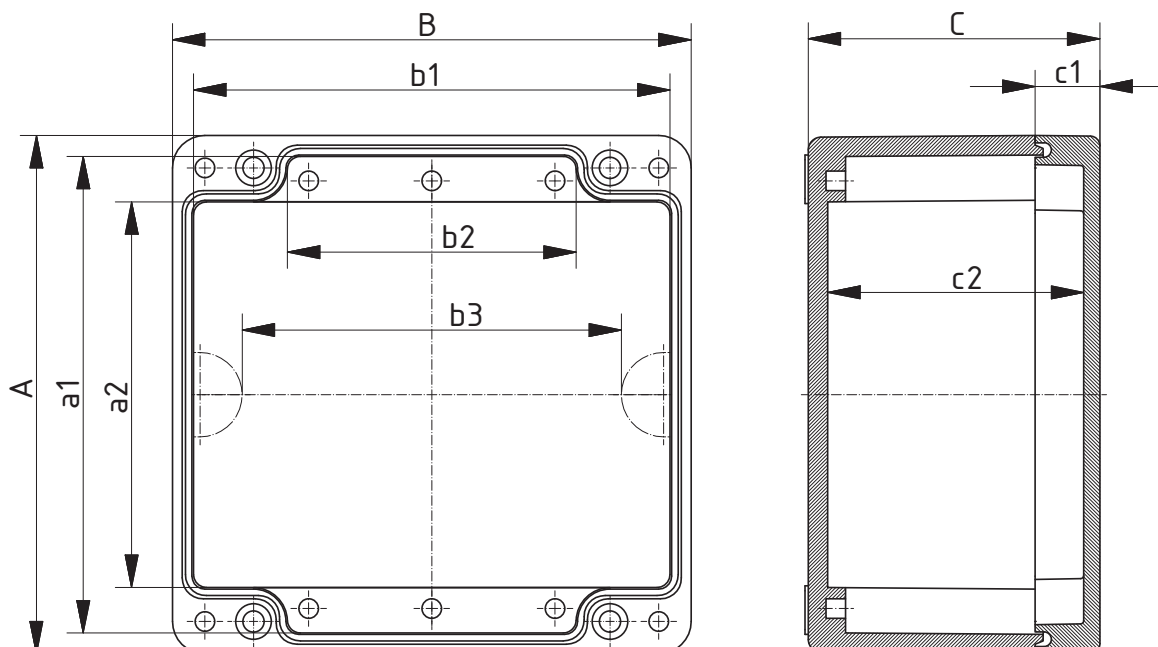

Z-2403295

For accessories, please see the end of the chapter

Euromas Polyester | accessories



Mounting panels, laminated paper (P 305-329) or galvanised sheet steel (P 330-355)

Model	Order no.	Note
M	24000100	For P 305
M	24000200	For P 311, P 324
M	24000300	For P 316, P 325
M	24000400	For P 319, P 329
M	21001700	For A 125, P 330
M	21001500	For A 122-123, P 331
M	21001600	For A 119-120, P 332
M	21001800	For A 130, P 333
M	21001900	For A 135, P 334
M	24000430	For P 336
M	24000440	For P 337-338
M	24000450	For P 339
M	24000460	For P 340, P 355
M	24000470	For P 341, P 3412
M	24000500	For P 342
M	21002000	For A 138, P 345

Scope of delivery: 1 mounting panel



Capstan-headed screws, sealable

Model	Order no.	Note
KP	21007905	For P 303, P 323
KP	21007935	For P 305-322, P 324-329
KP	21007975	For A 195, P 330, P 333-336, P 339, P 345
KP	21007995	For A 120-121, A 123, A 126-127, A 131, P 331-332, P 337, P 341-342, P 335
KP	21008025	For P 338, P 340

Scope of delivery: 2 pieces



Allen cheese-head screw for lid

Model	Order no.	Note
IS	21007900	For P 303, P 323
IS	21007930	For P 305-319, P 324-326, P 329
IS	21007940	For P 322, P 327
IS	21007970	For A 195, P 330, P 333-336, P 339
IS	21007990	For A 120-121, A 123, A 126-127, A 131, P 331-332, P 337, P 341, P 3412, P 355
IS	21008020	For P 338, P 340
IS	21008000	For P 342
IS	21007980	For P 345

Scope of delivery: 4 pieces



Earthing bars with fitted terminal clamps

Model	Order no.	Note
E	21004800	For A 125, P 330
E	21004700	For A 122-123, P 331
E	21004600	For A 119-120, P 332
E	21004900	For A 130, P 333, P 337-338
E	21005000	For A 124, A 135, P 334, P 339
E	21005400	For A 168, A 170-190, P 340-341, P 3412, P 355
E	21005500	For A 169, P 342
E	21005100	For A 138, P 345

Scope of delivery: 1 earthing bar

Euromas Polyester | accessories

Wall brackets, screw-on at rear

Model	Order no.	Note
WL	21004250	For A 114, A 116, A 118, P 305-322, P 324-329
WL	21004300	For A 119-198, P 330-355

Scope of delivery: 4 pieces



DIN rails DIN EN 60715 TH 15

Model	Order no.	Note
TS 15	21002800*	For A 105, P 305, P 326, PK 105
TS 15	24003100	For P 311, P 324
TS 15	21003150	For A 118, P 316
TS 15	24003300	For A 106, P 319, P 329
TS 15	24003310	For P 322, P 327, P 331
TS 15	22002000	For M/T 219-220, M/T 231-235, M/T 238, M/T 246, P 325, M/T 2381
TS 15	22001901	For P 330
TS 15	21003205	For A 119-120, P 332
TS 15	21003505	For A 130, P 333
TS 15	24003400	For P 336

Scope of delivery: 1 DIN rail



DIN rails DIN EN 60715 G 32

Model	Order no.	Note
TS 32	22001701	For M/T 210, M/T 225, P 305, P 326
TS 32	22002010	For M/T 219-220, M/T 231-235, M/T 238, M/T 246, P 316, P 325, M/T 2381
TS 32	24003410	For P 319, P 329
TS 32	24003311	For P 322, P 327
TS 32	21003400	For A 125, P 330
TS 32	21003300	For A 122-123, P 331
TS 32	21003200	For A 119-120, P 332
TS 32	21003500	For A 130, P 333
TS 32	21003340	For A 124, A 135, P 334, P 339
TS 32	24003750	For P 337-338
TS 32	21004100	For A 168, A 170-190, P 340-341, P 3412, P 355
TS 32	21004150	For A 169, A 196-197, P 342
TS 32	21003700	For A 138, P 345

Scope of delivery: 1 DIN rail



Euromas Polyester | accessories



DIN rails DIN EN 60715 TH 35

Model	Order no.	Note
TS 35	22001702	For M/T 210, M/T 225, P 305, P 326
TS 35	22002020	For M/T 219-220, M/T 231-235, M/T 238, M/T 246, P 316, P 325, M/T 2381
TS 35	24003315	For P 319, P 329
TS 35	24003312	For P 322, P 327
TS 35	21003410	For A 125, P 330
TS 35	21003320	For A 122-123, P 331
TS 35	21003210	For A 119-120, P 332
TS 35	21003510	For A 130, P 333
TS 35	21003350	For A 124, A 135, P 334, P 339
TS 35	24003760	For P 337-338
TS 35	21004110	For A 168, A 170-190, P 340-341, P 3412, P 355
TS 35	21004160	For A 169, A 196-197, P 342
TS 35	21003710	For A 138, P 345

Scope of delivery: 1 DIN rail



Set of hinges

Model	Order no.
SCHD	21007800

Scope of delivery: 1 set of diecast hinges

Note: Processing of the enclosure and mounting on request.

